**Features**

- n International standard package
 - n Planar glassivated chips
- Typical Applications**
- n High power rectifiers
 - n Field supply for DC motors
 - n Power supplies

$I_{F(AV)}$	60A
V_{RRM}	1000~1600V
I_{FSM}	600 A
I^2t	1800 A²s

SYMBOL	CHARACTERISTIC	TEST CONDITIONS		$T_j(^{\circ}\text{C})$	VALUE			UNIT
					Min	Type	Max	
$I_{F(AV)}$	Mean forward current	180° half sine wave 50Hz Double side cooled,	$T_C=100^{\circ}\text{C}$	175			60	A
$I_{T(RMS)}$	RMS on-state current						94	A
V_{RRM}	Repetitive peak reverse voltage	tp=10ms		175	1000		1600	V
I_{RRM}	Repetitive peak current	at V_{RRM}		175			10	mA
I_{FSM}	Surge forward current	10ms half sine wave		175			600	A
I^2t	I^2t for fusing coordination	$V_R=0.6V_{RRM}$					1800	A ² s
V_{FO}	Threshold voltage			175			0.85	V
r_F	Forward slope resistance						2.3	mΩ
V_{FM}	Peak forward voltage	$I_{FM}=180\text{A}$		25			1.60	V
$R_{th(j-c)}$	Thermal resistance Junction to case	Clamping force 2.4kN					1.08	$^{\circ}\text{C}/\text{W}$
M_s	To heatsink				2.4		2.9	N·m
T_{stg}	Stored temperature				-40		175	$^{\circ}\text{C}$
T_{jm}	Junction temperature				-40		175	$^{\circ}\text{C}$
W_t	Weight					15		g
Outline	ZL06、ZL06A							

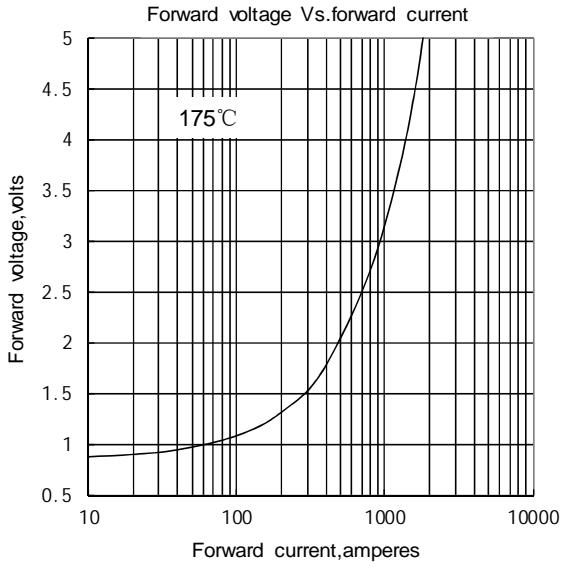

Fig.1

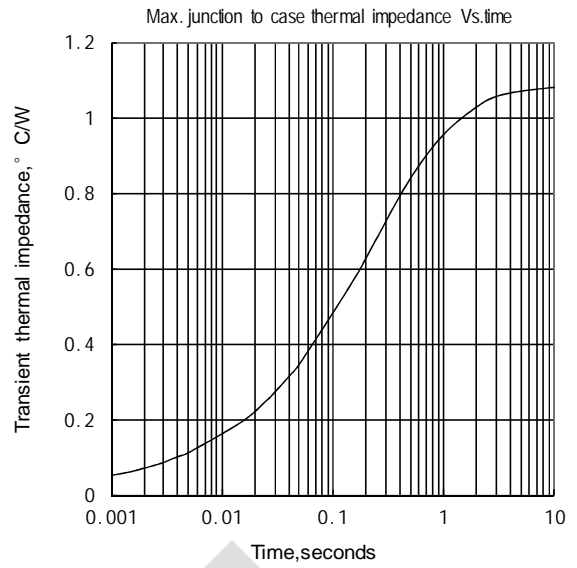

Fig.2

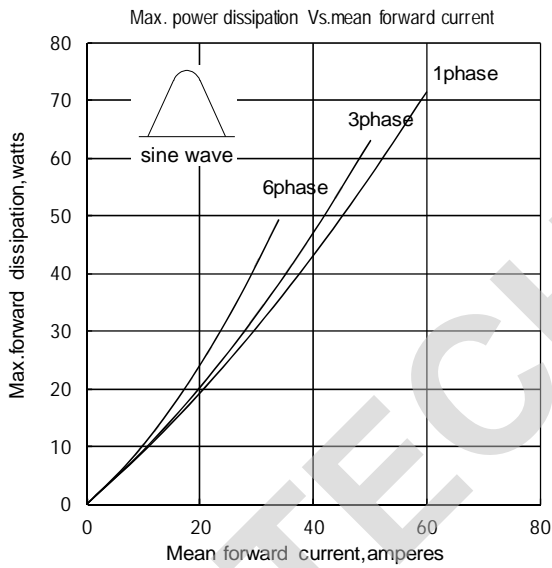

Fig.3

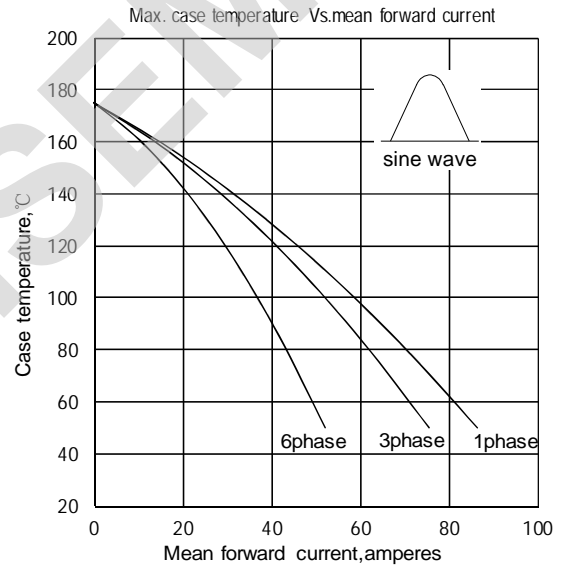

Fig.4

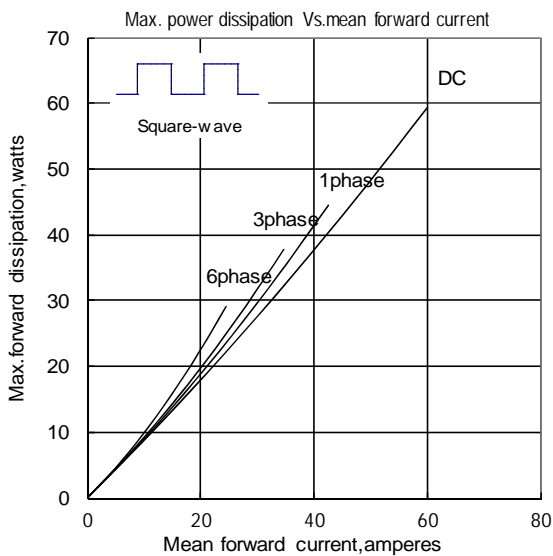

Fig.5

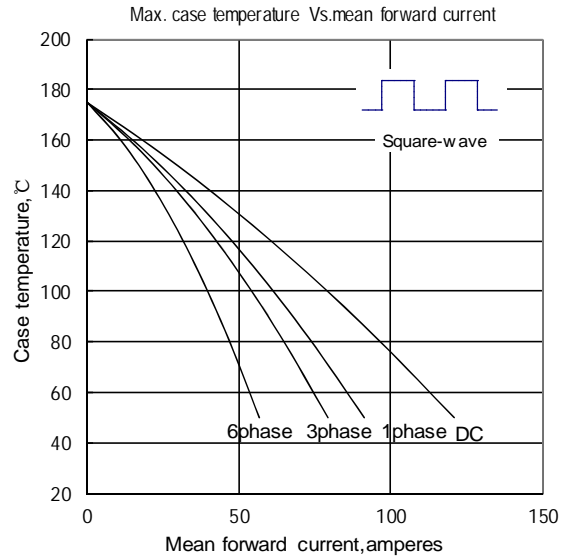

Fig.6

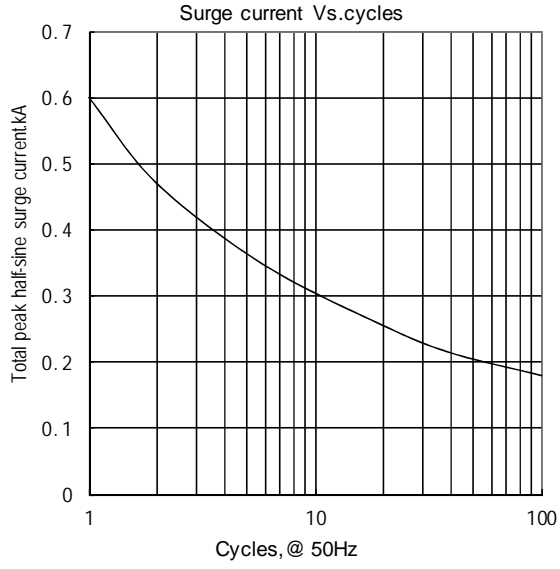

Fig.7

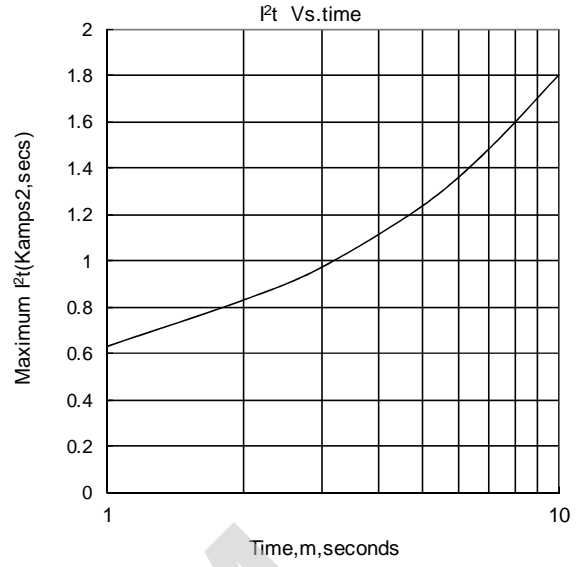
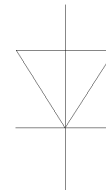
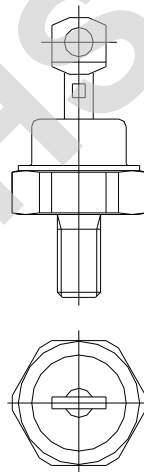
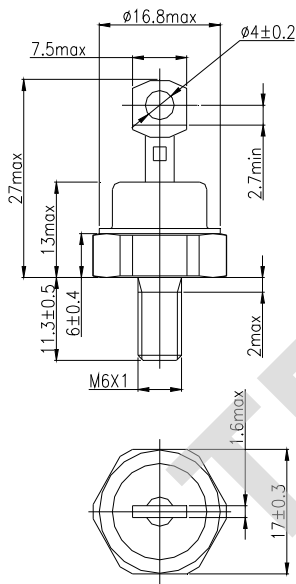
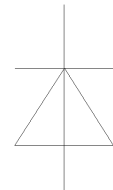

Fig.8

Outline:



ZL06



ZL06A

TECHSEM reserves the right to change specifications without notice.